



Public Works Department
Special Districts
CSA70-Wonder Valley and CSA20-Joshua Tree

Proposed Community Improvement Projects

Special Funding Opportunities
Project Details & Community Input

Frank Haggard
Recreation Superintendent
December 16, 2020

- With the recent approval of the updated Countywide Plan, San Bernardino County Special Districts Department has been tasked with actively pursuing grant opportunities that support various action items identified by the various communities.
- We currently have the opportunity to apply to the State of California Office of Grants and Local Services, OGALS, for Proposition 68 funds, approved by CA voters in 2018 in order to upgrade recreational facilities and supporting amenities such as community centers located nearby. The minimum amount to be applied for is \$200,000. There is no matching component required. Today's presentation helps us meet a grant requirement of facilitating at least five public forums during which public input is solicited.
- Special Districts has identified two projects that we believe would be both competitive applications and provide great benefits to the Morongo Basin.

Project 1

- For CSA70M – Wonder Valley we propose applying for funding to upgrade the Wonder Valley Community Center Kitchen and restroom area in order to address Public Health requirements of a Commercial Kitchen. This would entail the installation of items such as a floor sink, floor drains, larger capacity water heater, new flooring and impermeable wall surfaces in kitchen and restrooms, as well as, the installation of a Reverse Osmosis Water Filtration system. We have an estimate to complete those upgrades from our Project Management department for \$100,000.
- As a means to getting to the \$200,000 minimum, we are proposing a \$100,000 replacement of the playground and swings in the Wonder Valley Park.

WVCC KITCHEN & PLAYGROUND PROJECT



- The completion of this project would address the Countywide Plan for Wonder Valley *Community Focus Statement A*, “Improve the delivery of essential services to the community” and *Statement C*, “Create more local activities for Wonder Valley residents”.
- Currently, the kitchen at the Community Center cannot be used to serve food to the public. A functional, permitted Commercial Kitchen would allow potential user groups to provide food at meetings and celebrations. Additionally, a Commercial Kitchen can be rented by local food preparers to make products for sale.
- New playground equipment would allow the District to comply with revised ADA standards and provide a safe and appealing area for local and visiting children to play.

The second grant application would allow CSA20 – Joshua Tree to complete Phase II of the Desert View Conservation Area, DVCA, Recreational Trails project.

The installation of additional informational kiosks, a viewing platform, park amenities such as benches and picnic tables along the designated trails, would address the Joshua Tree Community *Focus Statements* to, “Conserve natural desert habitats and wildlife corridors and to protect native plants and animals”, “Connect existing designated open spaces with Joshua Tree National Park”, and “Develop recreational facilities”.

DESERT VIEW CONSERVATION AREA



RECREATIONAL TRAILS PROJECT – PHASE II

1. PUBLIC EDUCATION

- Established staging area with informational kiosk, shade structure, parking areas and single pit restroom
- Installed main Conservation Area entry gate and signage

2. HABITAT CONSERVATION

- Installed additional gates and decommissioned roads in sensitive habitat areas

3. DEFINE ACCEPTABLE USE OF AREA

- Completed 3 miles of trail alignment, directional signage and distance markers

1. Provide Additional Public Education

- Install additional informational kiosks
- Implement environmental education/conservation programs
- Promote stewardship and advocacy
- Foster partnerships with local user groups

2. Increase Management Strategies for Preservation of Sensitive Habitat

- Install boulder and chain barrier along vehicle routes
- Install additional signage along trails
- Revegetate blighted areas

3. Install Additional Amenities that Support Outdoor Recreation

- Provide destination points along trails i.e. kiosks, viewing platform, special interest areas, etc.
- Include rest areas with picnic tables, benches, small shade elements

PROPOSED SITE PLAN

DESERT VIEW CONSERVATION AREA SITE MAP

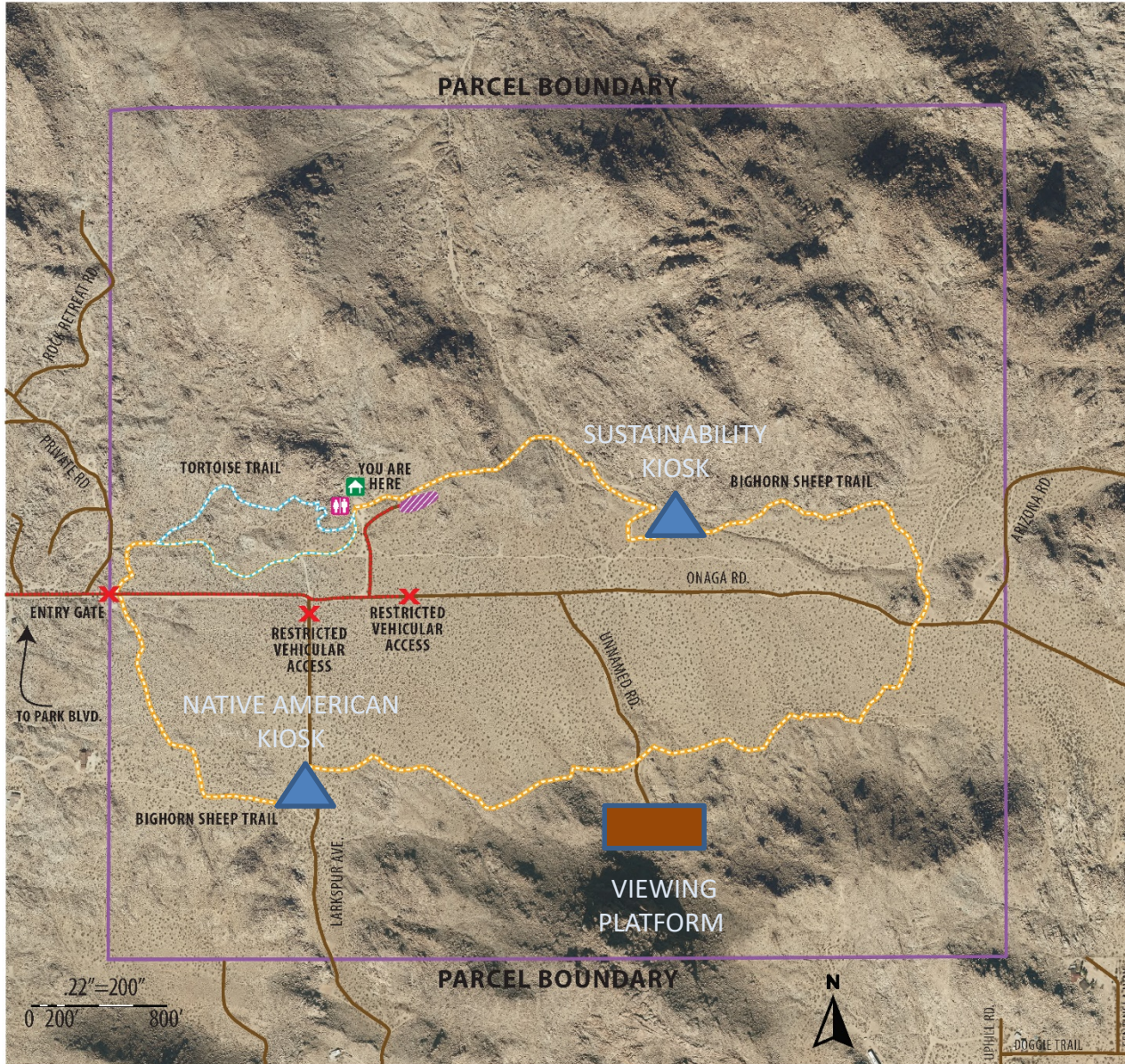

-  DVCA AREA BOUNDARY
-  TORTOISE LOOP TRAIL (0.6 Miles)
-  BIGHORN SHEEP TRAIL (2.5 Miles)
-  ACCESS ROADS
-  ACCESS POINT ROADS
-  RESTROOM (APPR. 125 s.f.)
-  JOSHUA TREE WOODLAND DISCOVERY SHELTER (APPR. 400-500 s.f.)
-  UNPAVED PARKING
-  RESTRICTED ACCESS POINTS



KIOSK AREAS OF FOCUS

- **VIEWING PLATFORM**
 - PLATFORM WITH STAIRS, RAILS AND INTEGRATED SEATING AREAS
 - PERMANENT BINOCULARS
 - DESCRIPTIONS OF VIEWS AND HIGHLIGHTS OF GEOGRAPHICAL FORMATIONS
 - DESERT BIG HORN SHEEP KIOSK
- **SUSTAINABILITY KIOSK**
 - ANCIENT PLANTS KIOSK
 - DISCUSSION OF HUMAN IMPACT ON ENVIRONMENT
 - SUSTAINABILITY AND ZERO-SCAPE DESIGN
 - SMALL SHADE STRUCTURE
- **NATIVE AMERICAN**
 - INFORMATIONAL KIOSK RE: HISTORICAL NA USE OF AREA, SACRED CEREMONY, ETC.
 - REPRESENTATION OF TYPICAL NA HOUSING
 - CULTURAL ARTIFACTS FOUND NEARBY
 - DESERT SURVIVAL SKILLS
 - SMALL SHADE STRUCTURE



We Need Your Help!

- We have created two brief surveys to capture input from the local community regarding these projects.
- Through the survey tool, in addition to commenting on the project components, there is an option to provide contact information.
- Individuals interested in participating in a project committee to establish design details and/or to contribute to the project in the areas of subject matter expertise, volunteer work or other support are requested to provide their contact information.

WVCC Kitchen & Playground

- Survey Link:

<https://specialdistricts.wufoo.com/forms/xd09r2u1qu4rdv/>

- Website:

www.wondervalley.org

DVCA Recreational Trails Phase II

- Survey Link:

<https://specialdistricts.wufoo.com/forms/x14n5snn0pzisjb/>

- Website:

www.joshuatreerecandpark.org

Contact:

Frank Haggard

frank.haggard@sdd.sbcounty.gov

PH: 760-366-8415