

# County of San Bernardino Surgarloaf RAP Slurry Seal Schedule

## Week 2

### Tuesday 9/5

PINE LANE	Clark Ln	to	NATIONAL FOREST	28,539	21
RINEHART LANE	PINE LANE	to	SPRUCE	3,435	3
BARTON LANE	PINE LANE	to	MAPLE LANE	13,000	10
WABASH LANE	BALDWIN	to	NATIONAL FOREST	105,100	78
VISTA LANE	BALDWIN	to	NATIONAL FOREST	109,998	81
				260,072	193

### Wednesday 9/6

SANTA BARBARA AVE	BALDWIN	to	MANZANITA LANE	23,016	17
SANTA BARBARA AVE	DIXIE LEE Ln	to	BARTON	28,728	21
SANTA BARBARA AVE	END OF COUNTY SECTION	to	NATIONAL FOREST	37,338	28
RIVERSIDE AVE	BALDWIN	to	BARTON	57,310	42
RIVERSIDE AVE	END OF COUNTY SECTION	to	NATIONAL FOREST	38,214	28
LAUREL LANE	MAPLE	to	SUNSET	31,960	24
CLARK LANE	LOS ANGELES	to	HOLMES LANE	25,560	19
				242,126	179

### Thursday 9/7

RINEHART LANE	MAPLE	to	CEDAR	3,451	3
CEDAR LANE	BALDWIN	to	NATIONAL FOREST	110,145	82
PINE LANE	BALDWIN	to	CLARK LANE	81,207	60
EUCALYPTUS LANE	MAPLE	to	SANTA BARBARA	63,640	47
				258,443	191

### Friday 9/8

ORANGE AVE	BARTON	to	NORTH END	9,450	7
INYO AVE	BARTON	to	NORTH END	8,180	6
BARTON LANE	ORANGE	to	INYO	4,300	3
MANZANITA LANE	SANTA BARBARA AVE	to	MAPLE	63,960	47
SPRUCE LANE	BALDWIN	to	NATIONAL FOREST	110,187	82
MAPLE LANE	BARTON	to	NATIONAL FOREST	54,222	40
				250,299	185

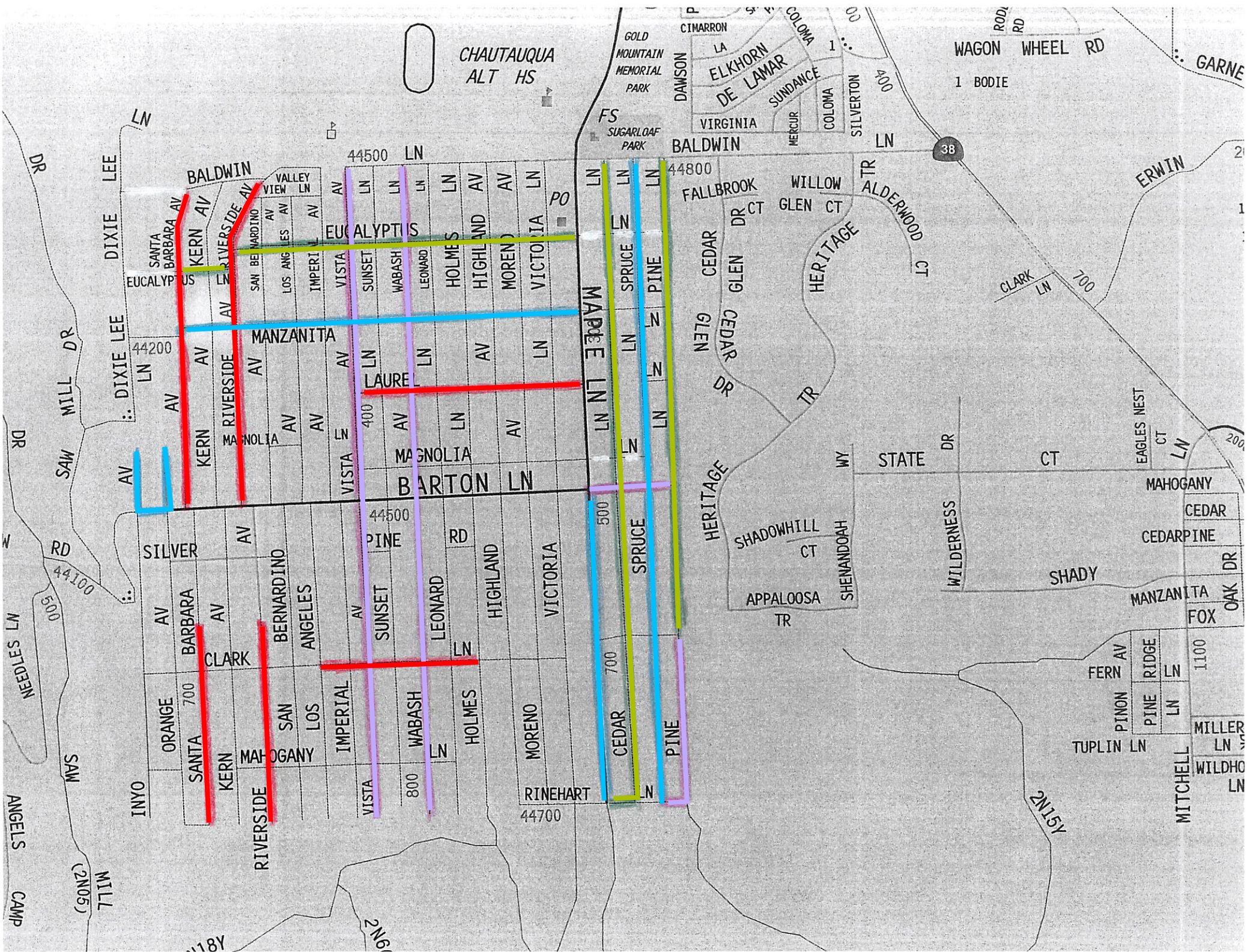

CHAUTAUQUA  
ALT HS

BALDWIN

MANZANITA

BARTON LN

MAPLE LN N1

SPRUCE LN N1

WAGON WHEEL RD

ANGELS CAMP  
MILL (2N05)

2N15Y

MILLER LN  
WILDHO LN

MITCHELL

TUPLIN LN

FERN AV

PINON AV

PINE RIDGE LN

MANZANITA OAK DR

CEDEAR PINE

MAHOGANY

EAGLES NEST CT

SHADY

WILDERNESS DR

STATE CT

SHENANDOAH WY

SHADOWHILL CT  
APPALOOSA TR

HERITAGE TR

HERITAGE TR

FALLBROOK DR CT  
CEDAR GLEN DR

HERITAGE TR

ALDERWOOD CT

WILLOW GLEN CT

BALDWIN

SUGARLOAF PARK

GOLD MOUNTAIN MEMORIAL PARK

DAWSON

VIRGINIA

ELKHORN DE LAMAR

SUNDANCE

COLOMA

COLOMA

COLOMA

SILVERTON

400

400

400

400

400

400

400

400

400

400

400

400

400

400

38

2

1

1

200

200

1100

1100

1100

1100

1100

1100

1100

1100